



### 9 Isabella Place LEETON NSW

4  2  6 

Positioned in a quiet Cul-De-Sac, 9 Isabella Place offers a modern and attractive home. Constructed in 2019, this property offers the perfect opportunity to walk into an established home without the long construction wait times.

As you enter this home, you're greeted with an abundance of space spread throughout the home from the wide hallway, open plan living, and large bedrooms, this home offers ample space for a large family.

The open plan kitchen-living-dining area is the heart of the home with large tile flooring throughout, a modern kitchen with a stone benchtop, and a butlers pantry for the cook in the family. This home also offers a second living space.

**Type** : House  
**Price** : \$ 800,000  
**Building Size** : 26 sqm  
**Land Size** : 1424 sqm  
**View** : <https://www.qplrural.com.au/sale/nsw/riverina/leeton/residential/house/7242675>



**Andrew Pellow**  
0269781008

[For full version visit the website](https://www.qplrural.com.au)

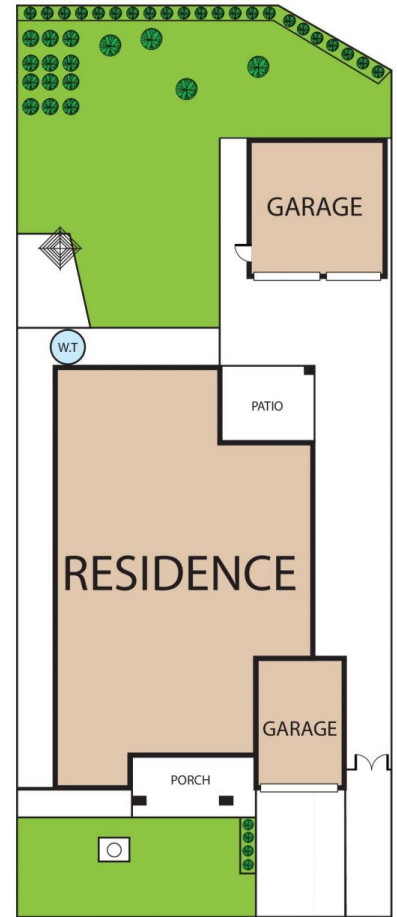

9 Isabella Place, Leeton 2705

TOTAL APPROX. FLOOR AREA 214 SQ.M

Whilst every attempt has been made to ensure the accuracy of the floor plan contained here, measurements of doors, windows, rooms and any other items are approximate and no responsibility is taken for any error, omission, or misstatement. This plan is for illustrative purposes only and should be used as such by any prospective purchaser.