



298 Burley Griffin Way TEMORA NSW

3  1  1 

The opportunity to purchase 25 acres* within the town limits of Temora.

The convenience of location combined with the privacy of no direct residential neighbours makes this a property not to be missed.

Features include:

- Original 3 bedroom homestead.
- Internally divided into 4 paddocks.
- Two stand shearing shed.
- Machinery/Hay shed.
- Elevated storage shed.
- Mains water connected.
- 1 Dam.
- Power connected.

[For full version visit the website](https://www.qplrural.com.au/sale/nsw/riverina/temora/residential/house/7242711)

Type : House
Price : \$ 755,000
Land Size : 101171 sqm
View : <https://www.qplrural.com.au/sale/nsw/riverina/temora/residential/house/7242711>



Lachlan Pellow
0269781008

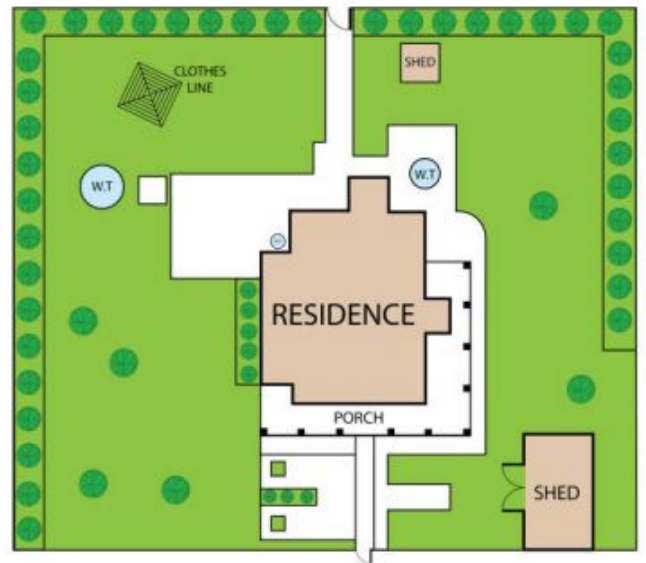

298 Burley Griffin Way, Temora 2666

TOTAL APPROX. FLOOR AREA 168 SQM

Whilst every attempt has been made to ensure the accuracy of the floor plan contained here, measurements of doors, windows, rooms and any other items are approximate and no responsibility is taken for any error, omission, or misstatement. This plan is for illustrative purposes only and should be used as such by any prospective purchaser.